



Cool Summer (TAIWAN) Inc.



WWW.CSIAIRSOFT.COM.TW

FOR AGE 18 YEARS OR OLDER
MADE IN TAIWAN

1.各部名稱 NAME OF PARTS

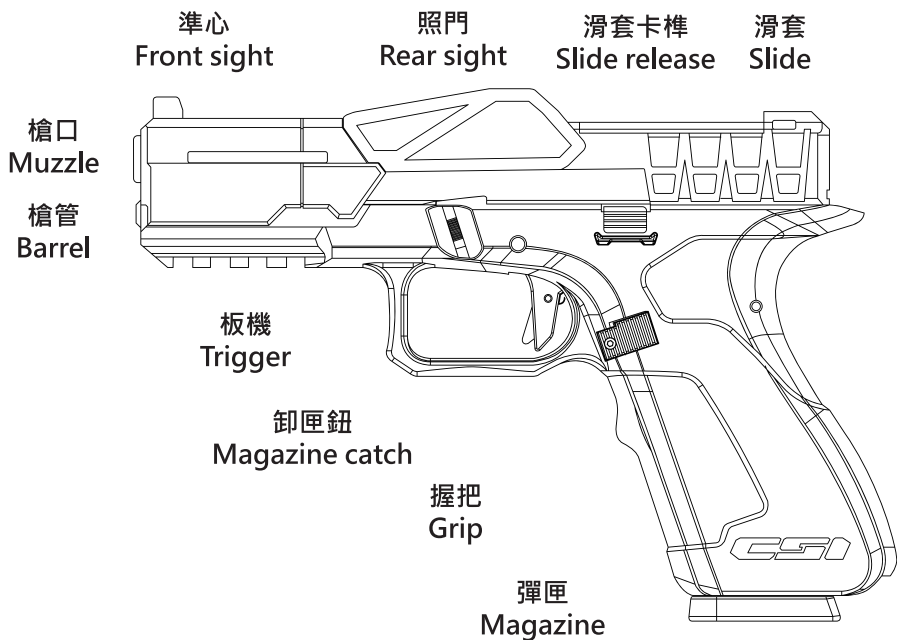

2.瓦斯注入方式 GAS INJECTION

瓦斯注入

填充氣體務必垂直

Gas injection

To refill the gas with the gas container in vertical position.

1. 向前推出彈匣底板

Press the magazine floor plate forward.

2. 垂直注入瓦斯

Injecting the gas vertical.

3. 推回彈匣底板

Press the magazine floor plate back.

注入瓦斯5-6秒
Press 5-6 sec

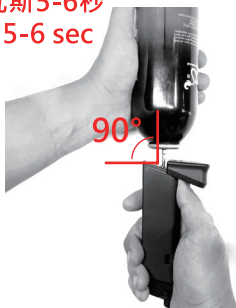

3. 彈匣裝填 MAGAZINE LOADING

BB彈裝填

裝填BB彈6mm (24+1發入)

Loading BB bullet

Load BB bullet in the magazine, 6mm (24+1 rounds only).

請依照圖示之排列方式裝填BB彈

Please follow the illustrative sequences to load the BB bullets.

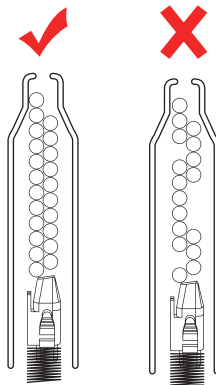
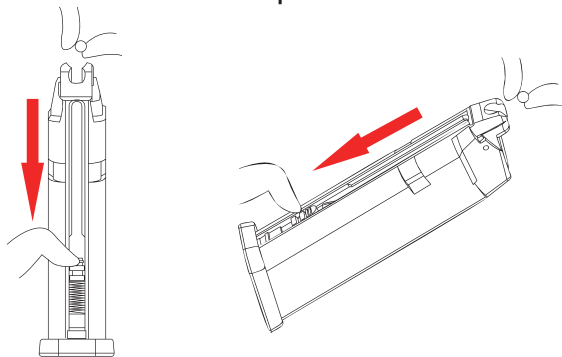

請勿使用超過6mm, 表面不平整或使用過之BB彈

Please do not use the BB bullets that are over 6mm, rough on surface or have been used.

4. 上彈匣 LOADING & RELEASING THE MAGAZINE

彈匣入退要點

入彈匣時推到底·如聽 " 搭 " 一聲即到定位點, 壓下卸匣鈕, 彈匣即會脫離

注意: 務必用手托住彈匣, 以免造成掉落破損

Load and release the magazine

While loading the magazine, push it inward to the bottom till a " tick " sound is heard. Press the magazine release catch, the magazine will fall off from the stock. Attention: use hand to receive the magazine to prevent it from falling down to the ground.



上彈匣時推到底, 如聽 " 搭 " 一聲, 即到定位
Loading the magazine, push it inward to the bottom till a " tick " sound is heard.



下彈匣時, 請用手托住彈匣, 避免掉落
Use hand to receive the magazine during releasing it to prevent it from falling down to the ground.

5. 單連發系統切換 SEMI / FULL AUTO SYS SWITCH

將滑套向後拉，將單連發選擇鈕往右移，即可切換至連發系統。

Pull the slide back and move the single firing selector to right, change to full auto mode.

單發切換至連發
Semi Auto switch to Full Auto



連發切換至單發
Full Auto switch to Semi Auto

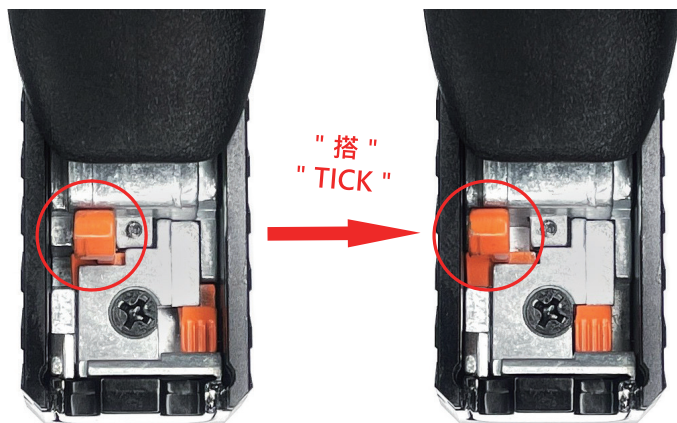

6. 爆炸圖 EXPLOSION

A 上滑套總成 Upper

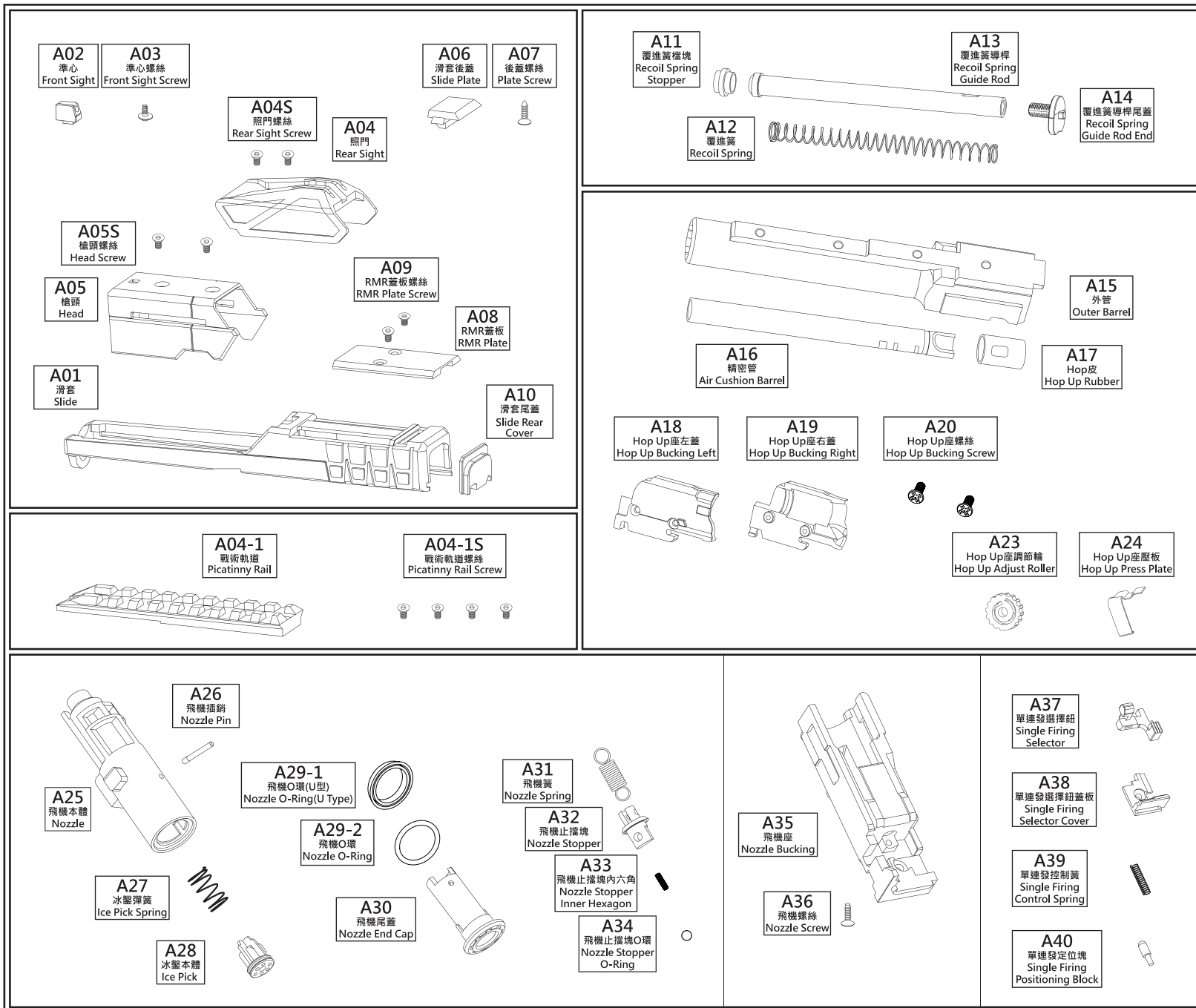

B 下槍身總成 Receiver

B01
下槍身
Frame

B02
滑套釋放桿
Slide Release

B03
滑套釋放桿彈簧
Slide Release Spring

B04
卸匣鈕彈簧
Magazine Release Button Spring

B05
卸匣鈕
Magazine Release Button

B08
板機保險插銷
Trigger Safety Pin

B10
板機連桿彈簧
Trigger With Trigger Bar Spring

B09
板機連桿
Trigger With Trigger Bar

B06
板機
Trigger

B11
板機連桿插銷
Trigger Bar Pin

B07
板機保險
Trigger Safety

B12
下身導軌
Lower Guide

B13
滑套釋放簧片
Slide Lock Spring

B14
滑套釋放簧片插銷
Slide Lock Spring Pin

B15
滑套釋放塊
Slide Lock

B17
下身導軌螺絲
Lower Guide Screw

B16
下導軌插銷
Lower Guide Pin

B21
撞針
Stinger

B22
司牙
Sear

B23
司牙彈簧
Sear Spring

B24
司牙插銷
Sear Pin

B25
切氣片
Air Cutting Blade

B26
切氣片彈簧
Air Cutting Blade Spring

B18
火控盒
Trigger Setting

B19
火控盒螺絲
Trigger Box Screw

B20
火控盒插銷
Trigger Setting Pin

B27
擊錘
Hammer

B28
擊錘彈簧
Hammer Spring

B29
擊錘培林
Hammer Bearing

B30
擊錘插銷
Hammer Pin

B31
脫離勾
Hammer Releaser

B32
脫離勾彈簧
Hammer Releaser Spring

B33
脫離勾插銷
Hammer Releaser Pin

C 彈匣 Magazine

C02
彈匣含彈嘴
Magazine Upper Cover

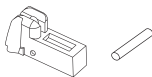

C03
彈匣含彈嘴插銷
Magazine Upper Cover Pin

C04
出氣橡皮
Magazine Vent Rubber



C01
彈匣本體
Magazine

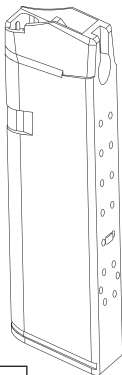

C05
出氣閥
Output Valve



C06
O環 (長螺絲)
O-Ring (Long Screw)



C07
彈匣底蓋螺絲
Magazine Insert Screw



C09
O環 (彈匣氣密底蓋)
O-Ring (Magazine Insert)



C10
彈匣氣密底蓋
Magazine Insert

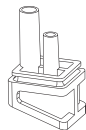

C08
進氣閥
Injection Valve



C11
頂彈桿(頭)
Magazine Top Bullet



C12
彈匣彈簧
Magazine Spring



C13
尾蓋卡榫
End Cap Latch



C14
彈匣底板
Magazine Floor Plate

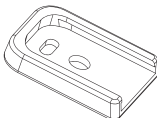

警告 WARNING

射擊時請戴護目鏡

Be sure to wear shooting glasses or Goggle when shooting.



不可用眼睛探視槍

Don't peep at the muzzle.



射擊的瞬間才可以把手指接近板機擊扣

Don't touch the trigger until the moment of shooting.



避免粗魯的動作，以免發生危險

Avoid a rough operation, in case get hurt.



不用時要把槍置於小孩拿不到的高處

Put the gun beyond the reach of kids.

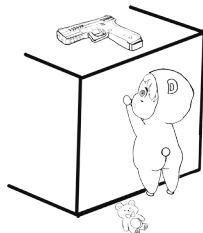

不可朝人、動物射擊

Don't aim at people, animal even if it is unloaded

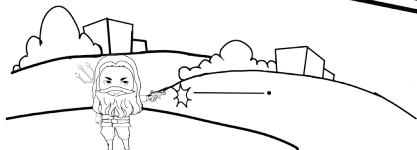

確定射擊的方向均安全後才可以射擊

After making sure that there is nobody nearby and can shooting.

不使用時，應將彈匣

取出，並取下子彈

When the gun is not in use, remove the magazine and unload BB Bullets.

